

210164-3 - MAST COMPLETE

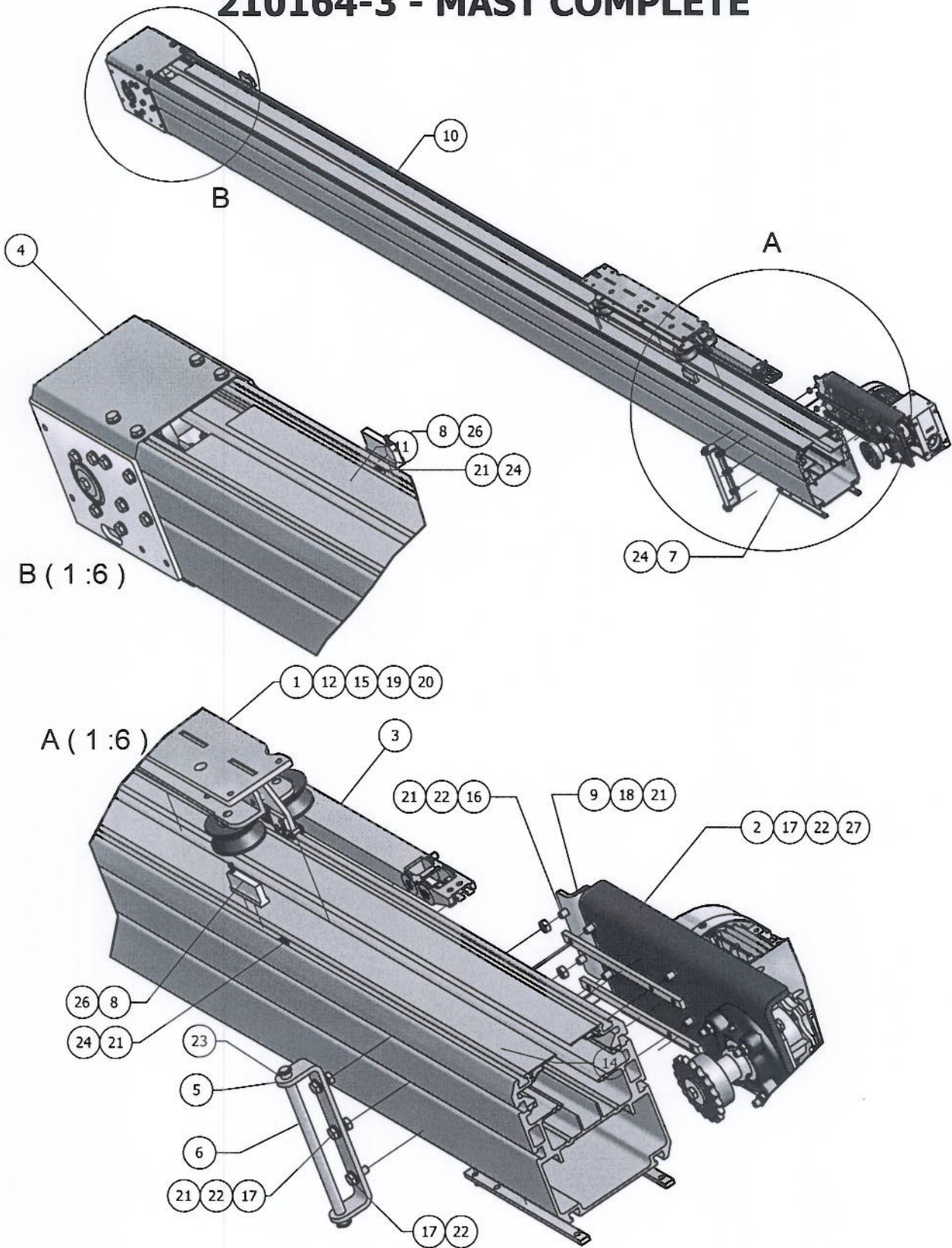

210164-3 - MAST COMPLETE

POS.	PART NO	REV.	DESCRIPTION	Q.	NOTICE
1	210162	1	CARRIAGE COMPLETE	1	
2	210304	A	MAST TRANSMISSION	1	
3	210305	A	Cable channel for mast L=3400mm GL2xx	1	
4	211050	0	Mast top (replacement for 210229)	1	
5	312063	A	SUPPORT	1	
6	312065	A	SHAFT	1	
7	312066	A	BARNUT	6	
8	312067	5	LIMIT POSITION UNIT	2	
9	312315	0	STRETCHING DEVICE	1	
10	320878		MAST 3400mm	1	
11	320906		COVER PLATE	2	
12	400350	0	LOCKING LINK RS08B	2	
13	400372	A	RUBBER CLIP 6MM	2	
14	400395	A	STRAP	6	
15	401559	A	ROLLER CHAIN RS 08B L=6134	1	
16	460017		SCREW M6S M8x16	2	
17	460018		M6S M8x20	7	
18	460019		SCREW M6S 8x30	1	
19	460094		SCREW MC6S M6x12	2	
20	460180		NUT M6M M6	2	
21	460181		NUT M6M 8	34	
22	460201		WASHER BRB 8,4	9	
23	460412	0	RETANINGRING SGA 12	2	
24	460543		STOPSCREW	8	
25	460665		SCREW MRT-M5x8	1	
26	460671		SCREW SK6SS - M5 x 5	2	
27	751062	A	CABLE FOR MAST MOTOR	1	